

Distributed by:

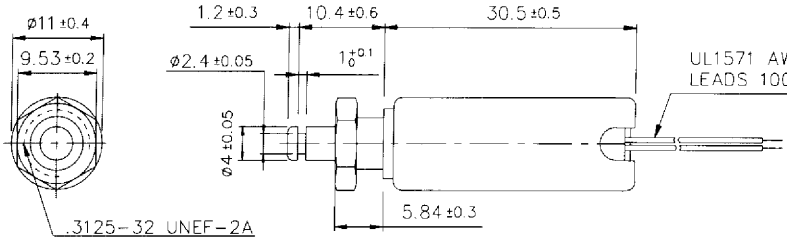

**[www.Jameco.com](http://www.Jameco.com) ♦ 1-800-831-4242**

The content and copyrights of the attached  
material are the property of its owner.

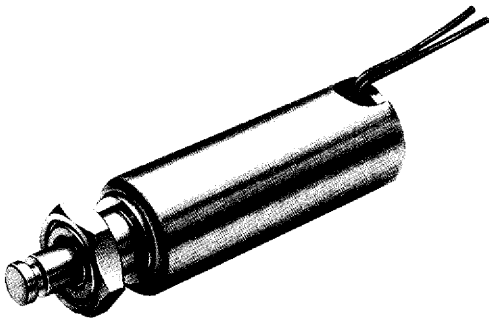

Plunger Weight 可動鐵心重量 : 3.2g  
Total Weight 總重量 : 17g

Shown Energized 通電狀態 UNIT 單位 : mm

## STROKE Vs FORCE 行程 / 吸引力

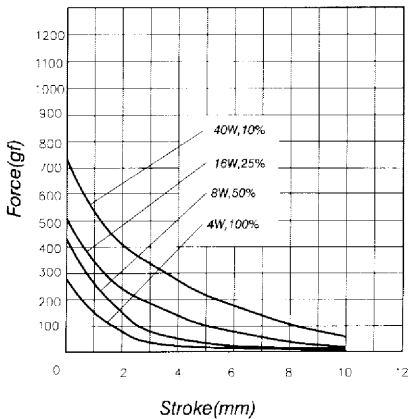

## STROKE Vs RESPONSE TIME 行程 / 反應時間

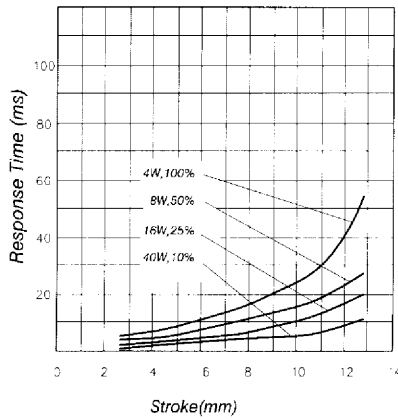

## AMPERE-TURNS Vs FORCE 安-匝 / 吸引力

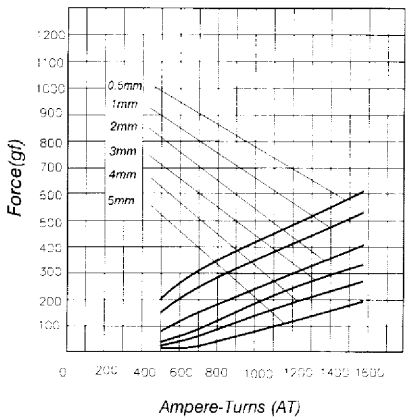

## COIL DATA 線圈資料

Heat Sink: 25 × 25 × 3mm (aluminum)  
散熱片 : 25 × 25 × 3mm (鋁)

| Duty cycle (%) = $\frac{\text{"ON" time}}{\text{"ON" time} + \text{"OFF" time}} \times 100\%$<br>作動週期 (%) = $\frac{\text{ON 時間}}{\text{ON 時間} + \text{OFF 時間}} \times 100\%$ |                              |           | Continuous (100%)<br>連續 (100%) | Or less (50%)<br>間斷 (50%) | Or less (25%)<br>間斷 (25%) | Or less (10%)<br>間斷 (10%) |
|--|------------------------------|-----------|--------------------------------|---------------------------|---------------------------|---------------------------|
| MAX. "on" time in seconds<br>最大 ON 時間 (秒)  |                              |           | ∞                              | 50                        | 5                         | 2                         |
| Watts at 20°C<br>瓦特數 (W) (在 20°C)  |                              |           | 4                              | 8                         | 16                        | 40                        |
| Ampere-turns at 20°C<br>AT 值 (在 20°C)  |                              |           | 497                            | 704                       | 994                       | 1573                      |
| Type no.   | Resistance (20°C)<br>Ω ± 10% | No. turns | Volts DC<br>電 壓                |                           |                           |                           |
| 型 號  | 阻值(Ω) ± 10%                  | 繞線圈數      |                                |                           |                           |                           |
| SMT-1130L06AA  | 9                            | 745       | 6                              | 8.5                       | 12                        | 19                        |
| SMT-1130L12AA  | 36                           | 1492      | 12                             | 17                        | 24                        | 38                        |
| SMT-1130L24AA  | 144                          | 2972      | 24                             | 34                        | 48                        | 76                        |
| SMT-1130L48AA  | 576                          | 5850      | 48                             | 68                        | 96                        | 152                       |